

Levy County, FL

Homestead Transfer Form (PDF Format)

[TRANSFER OF HOMESTEAD ASSESSMENT DIFFERENCE - DR501T Form \(pdf format\)](#)

Homestead Application

Homestead Application

Hurricane Damage Form

ATTENTION: This is not for FEMA.

Hurricane Damage Form

Application for Catastrophic Event Tax Refund

ATTENTION: Please read instructions carefully

Instructions

Application for Catastrophic Event Tax Refund

Summary

Parcel ID	0651200000
Location Address	319 MONGO ST BRONSON 32621-
Neighborhood	05.00 (5)
Legal Description*	17-12-17 0009.00 AC COULTER'S PLAT LOTS 23 24 25 26 27 28 & 34 AND TRACT IN NE1/4 OF NW1/4 ANDTRACT 210 X 210 FT OR BOOK 1470 PAGE 478 <i>*The legal description shown here may be condensed, a full legal description should be obtained from a recorded deed for legal purposes.</i>
Property Use Code	COUNTY (8600)
Subdivision	COULTERS PLAT TO BRONSON
Sec/Twp/Rng	17-12-17
Tax District	BRONSON SW (District BRSW)
Millage Rate	19.334
Acreage	9.000
Homestead	N
Ag Classification	No

[View Map](#)

Owner

Owner Name	Levy Bocc 100%
Mailing Address	PO BOX 310 BRONSON, FL 32621

Estimate Taxes

Estimate Taxes

Valuation

	2025 Preliminary Value Summary
Building Value	\$561,432
Extra Features Value	\$13,903
Market Land Value	\$240,671
Ag Land Value	\$240,671
Just (Market) Value	\$816,006
Assessed Value	\$816,006
Exempt Value	\$816,006
Taxable Value	\$0
Save Our Homes Benefit	\$0
Previous Year Value	\$816,006

Exemptions

Homestead	2nd Homestead	Widow/er	Disability	Seniors	Veterans	Other
-----------	---------------	----------	------------	---------	----------	-------

Building Information

Building	1	Roof Cover	ASPHALT/COMP SHG
Actual Area	7544	Heating Type	FORCED AIR DUCTED
Conditioned Area	7484	Air Conditioning	CENTRAL
Actual Year Built	1980	Baths	
Effective Year Built	1991		
Use	SCHOOL		
Exterior Wall	CONCRETE BLOCK		
Roof Structure	GABLE OR HIP		

Description	Conditioned Area	Actual Area
BASE	7484	7484
CANOPY	0	30
CANOPY	0	30
Total SqFt	7484	7544

Building	2	Roof Cover	METAL
Actual Area	11978	Heating Type	CONVECTION
Conditioned Area	11948	Air Conditioning	NONE
Actual Year Built	1975	Baths	
Effective Year Built	1977		
Use	SCHOOL		
Exterior Wall	CONCRETE BLOCK		
Roof Structure	GABLE OR HIP		

Description	Conditioned Area	Actual Area
BASE	11948	11948
CANOPY	0	30
Total SqFt	11948	11978

Extra Features

Code Description	BLD	Length	Width	Height	Units
SEE XF NOTES	0	0	0	0	1
CHAIN FENCE 6	0	0	0	0	1180

Land Line

Use Description	Front	Depth	Total Land Units	Unit Type	Land Value
SCHOOL	0	0	8.82	AC	\$240,671

Sales

Sale Date	Sale Price	Instrument Type	Book	Page	Qualification	Vacant/Improved	Grantor	Grantee
9/21/2018	\$100.00	WM	1469	922	U	I	LEVY COUNTY	LEVY COUNTY SCHOOL BOARD
8/15/2018	\$100.00	FS	1470	474	U	I	TOWN OF BRONSON	LEVY COUNTY SCHOOL BOARD
8/14/2018	\$0.00	FS	1470	478	U	I	LEVY COUNTY SCHOOL BOARD	LEVY COUNTY
4/1/1994	\$10,500.00	WD	522	550	U	I	ROBINSON FREDDIE LEE SR & FREDDIE MAY	SCHOOL BOARD OF LEVY COUNTY
8/1/1990	\$4,000.00	WD	406	419	U	V	WHITE JUANITA J	SCHOOL BOARD OF LEVY COUNTY
5/1/1990	\$2,000.00	WD	392	580	U	V	WHITEHURST V E & FLORELLE	SCHOOL BOARD OF LEVY COUNTY
6/16/1950	\$0.00	WD	49	409	Q	I	MCCRAY LILLIE MILLER PINES-HEIRS	LEVY COUNTY SCHOOL BOARD
1/31/1950	\$0.00	WM	49	172	Q	I	COULTER WILIAM R	LEVY COUNTY SCHOOL BOARD

Building Sketch

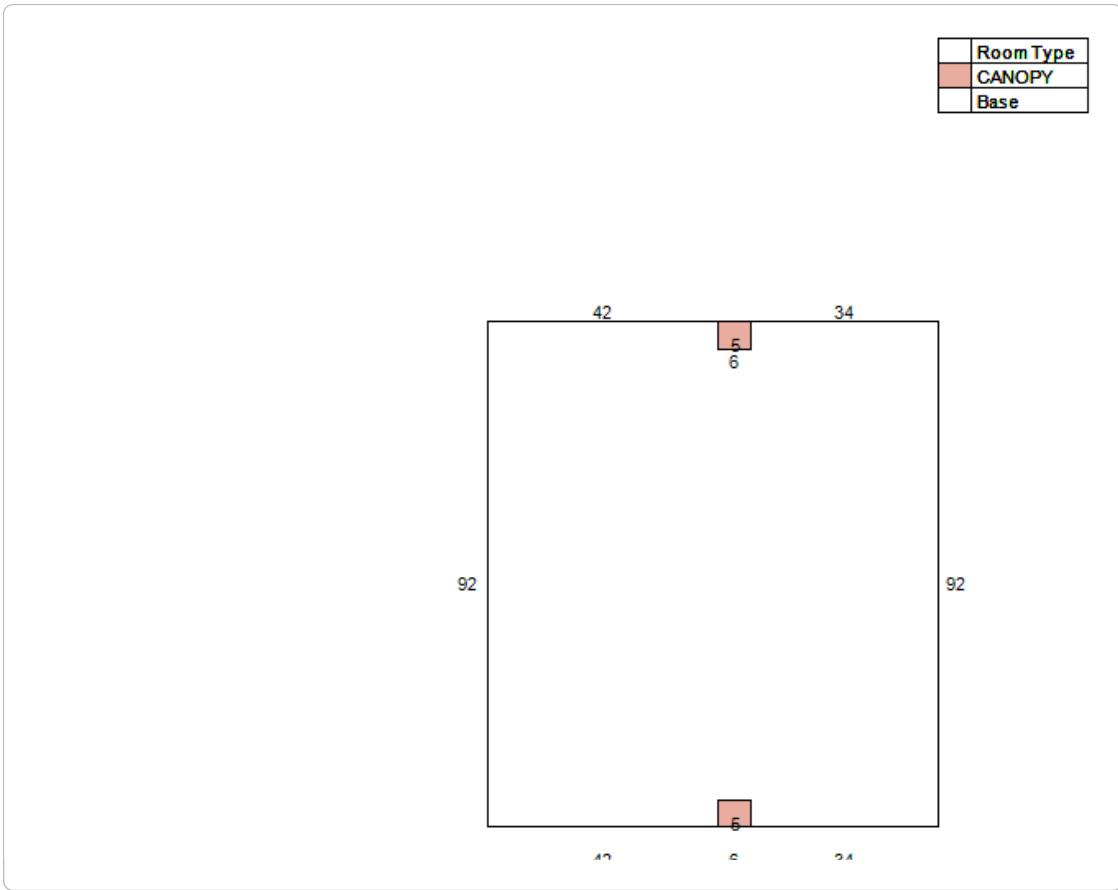

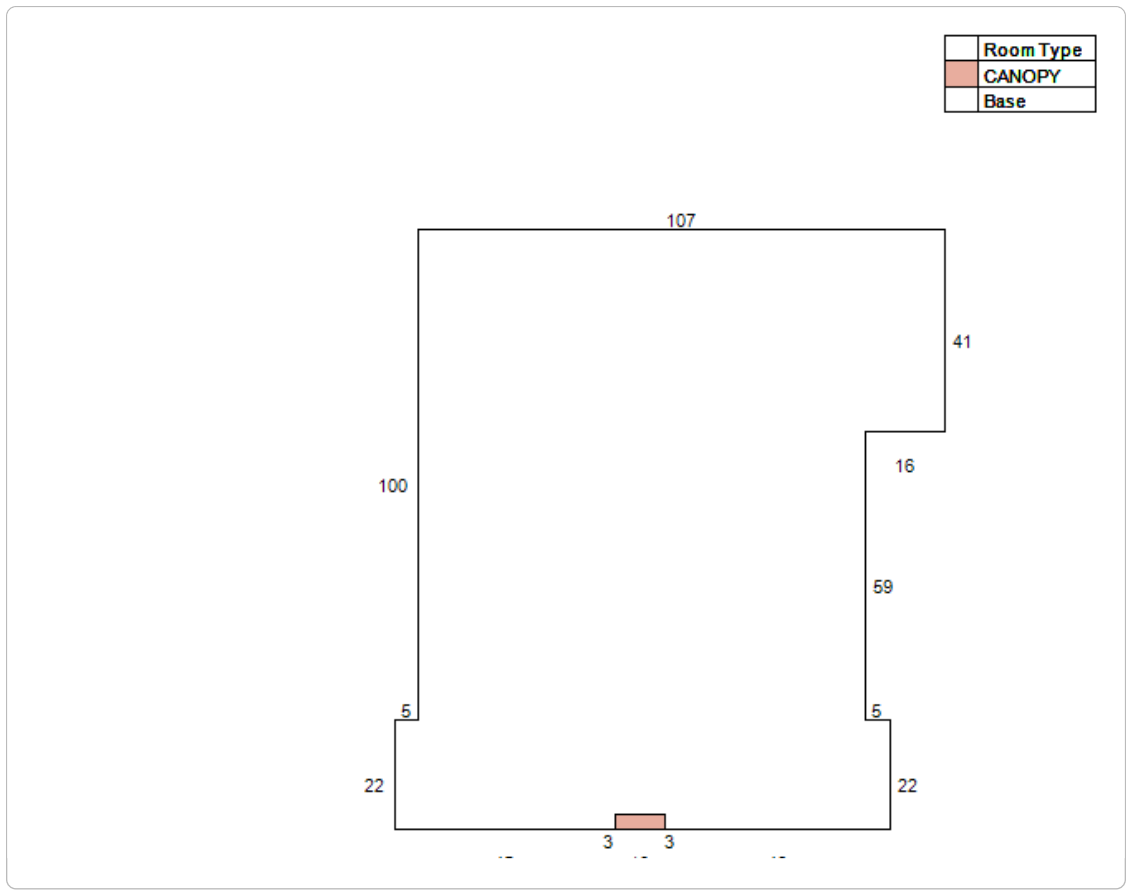

Map



No data available for the following modules: Trim Notice, Photos.

Levy County makes every effort to produce the most accurate information possible. No warranties, expressed or implied, are provided for the data herein, its use or interpretation.
 | [User Privacy Policy](#) | [GDPR Privacy Notice](#)
 Last Data Upload: 2/6/2025, 7:29:59 PM

Contact Us

